

F22 Aluminum Profile

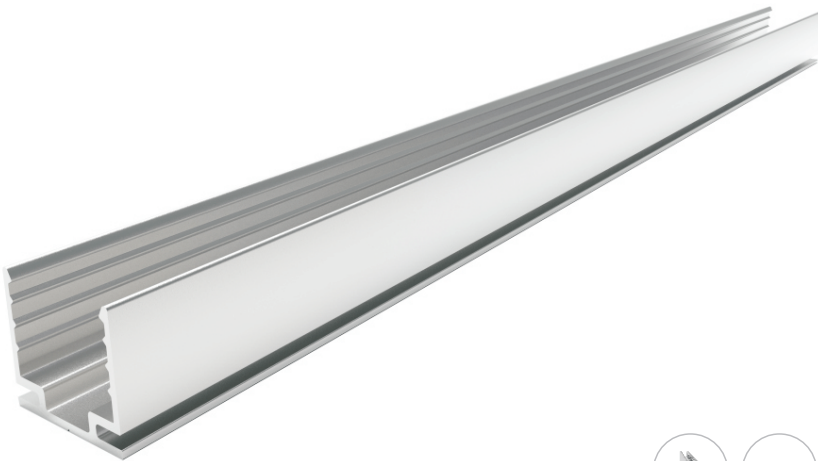

It uses high-quality 6063 aluminum with thin-wall, light-weight design to fit tightly the light body. It is deformation and rust resistant, and cost-effective.



Please refer to the applicable installation ways.

Test Object	No.	Experiment Item	Standard
Metal Parts	1	Weather Resistance-Salt Spray	IEC 68-2-11
Mounting profile	2	Clamping force	CLEAR-defined

Dimension: mm

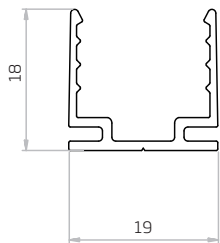

Tolerance: $\pm 0.3\text{mm}$

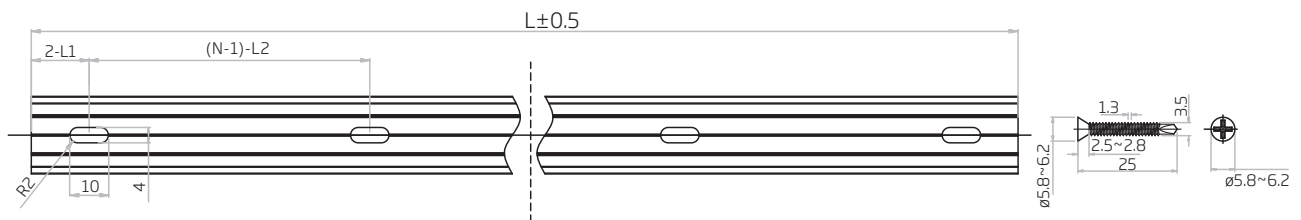
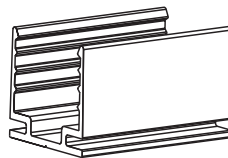

Note:

1. 2-L1 refers to two of symmetric L1 in each piece of profile.
 2. (N-1)-L2 refers to (N minus one) of symmetric L2 in each piece of profile.
- "N" hereby stands for its corresponding "Hole Number" in the below table.

Item Code	Standard Length	L1	L2	Slotted Hole	Hole Number
F22-A/PL-35MM-AL	35mm/1.38in	17.5mm/0.69in	/	4*10mm/0.16*0.39in	1
F22-A/PL-500MM-AL	500mm/19.68in	50mm/1.97in	200mm/7.87in	4*10mm/0.16*0.39in	3
F22-A/PL-1000MM-AL	1000mm/39.37in	100mm/3.93in	200mm/7.87in	4*10mm/0.16*0.39in	5
F22-A/PL-2000MM-AL	2000mm/78.74in	100mm/3.93in	200mm/7.87in	4*10mm/0.16*0.39in	10

F22 Flange Aluminum Profile

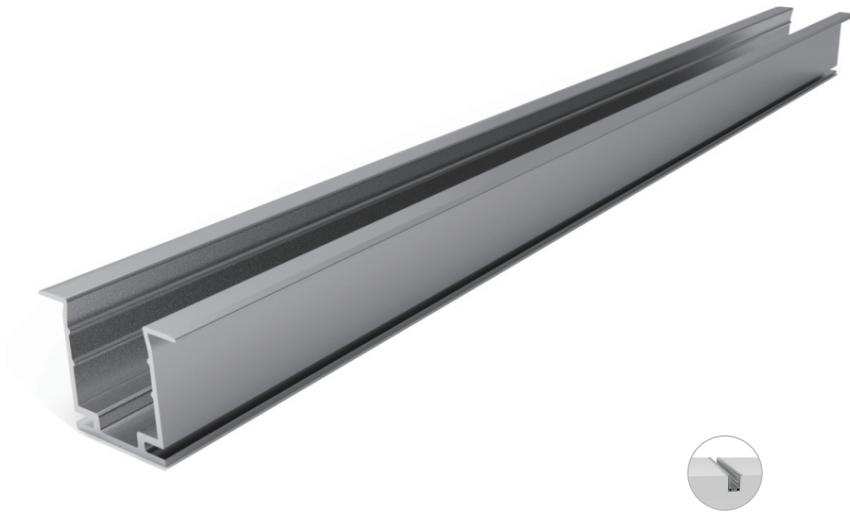

It uses high-quality 6063 aluminum with thin-wall, light-weight design to fit tightly the light body. It is deformation and rust resistant, and cost-effective. The "Flange" design is more suitable for recessed installation, better fits with the mounting groove and minimizes the operation tolerance during construction to some extent, like shielding the rough edges and the gaps of oversized groove.

Please refer to the applicable installation way.

Test Object	No.	Experiment Item	Standard
Metal Parts	1	Weather Resistance-Salt Spray	IEC 68-2-11
Mounting profile	2	Clamping force	CLEAR-defined

Dimension: mm

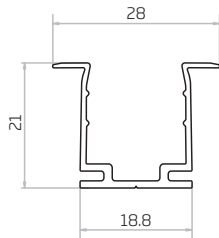

Tolerance: $\pm 0.3\text{mm}$

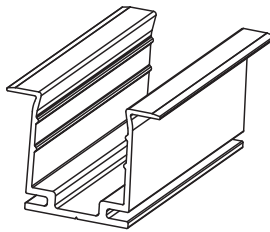

$L \pm 0.5$

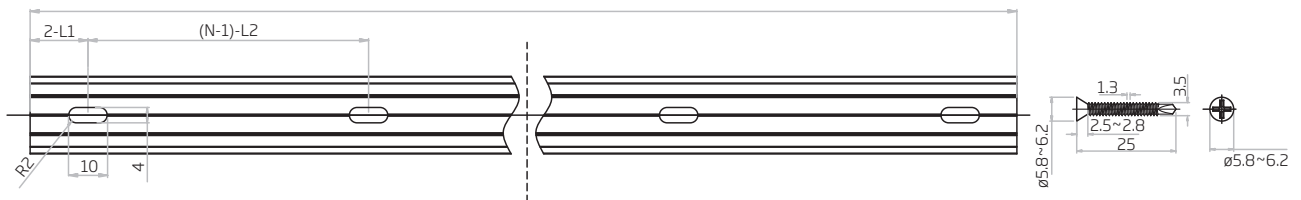

Note:

- 2-L1 refers to two of symmetric L1 in each piece of profile.
 - (N-1)-L2 refers to (N minus one) of symmetric L2 in each piece of profile.
- "N" hereby stands for its corresponding "Hole Number" in the below table.

Item Code	Standard Length	L1	L2	Slotted Hole	Hole Number
F22-FA/PL-35MM-AL	35mm/1.38in	17.5mm/0.69in	/	4*10mm/0.16*0.39in	1
F22-FA/PL-500MM-AL	500mm/19.68in	50mm/1.97in	200mm/7.87in	4*10mm/0.16*0.39in	3
F22-FA/PL-1000MM-AL	1000mm/39.37in	100mm/3.93in	200mm/7.87in	4*10mm/0.16*0.39in	5
F22-FA/PL-2000MM-AL	2000mm/78.74in	100mm/3.93in	200mm/7.87in	4*10mm/0.16*0.39in	10

F22 Thickened Plastic Profile

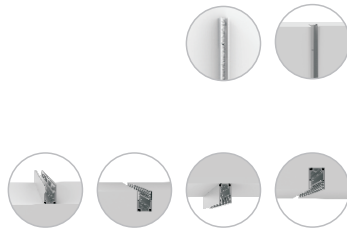

It uses thickened PC profile to 3mm thickness, specialized for underwater application up to 5m depth, and has excellent properties in rust, corrosion and fracture resistance.

Please refer to the applicable installation ways.

Test Object	No.	Experiment Item	Standard
Mounting profile	1	Clamping force	CLEAR-defined

Dimension: mm

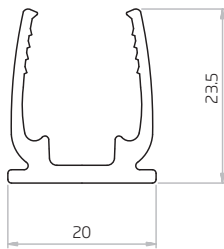

Tolerance: $\pm 0.5\text{mm}$

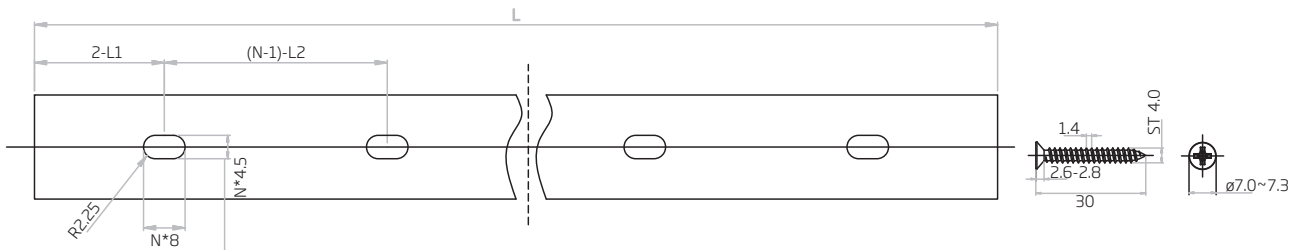
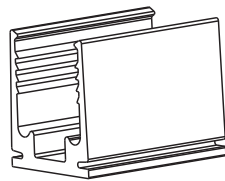

Note:
 1. 2-L1 refers to two of symmetric L1 in each piece of profile.
 2. (N-1)-L2 refers to (N minus one) of symmetric L2 in each piece of profile.
 "N" hereby stands for its corresponding "Hole Number" in the below table

Item Code	Standard Length	L1	L2	Slotted Hole	Hole Number
F22-TP/PL-35MM-TT	35mm/1.38in	17.5mm/0.69in	/	4.5*8mm/0.18*0.31in	1
F22-TP/PL-500MM-TT	500mm/19.68in	50mm/1.97in	200mm/7.87in	4.5*8mm/0.18*0.31in	3
F22-TP/PL-1000MM-TT	1000mm/39.37in	100mm/3.93in	200mm/7.87in	4.5*8mm/0.18*0.31in	5
F22-TP/PL-2000MM-TT	2000mm/78.74in	100mm/3.93in	200mm/7.87in	4.5*8mm/0.18*0.31in	10

F22 Stainless Steel Profile

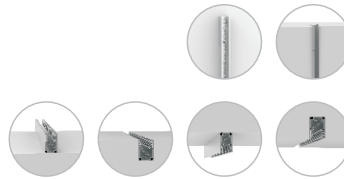

It uses grade 316 stainless steel with excellent property of deformation and rust resistance. The material makes it suitable for humid coastal surroundings and weak acid-base industrial environments that other mounting profiles can't accommodate. The structural design and material characteristics collectively ensure a tight clamping force. It's very convenient and reliable even for suspended installation in the curve shape.

Please refer to the applicable installation ways.

Test Object	No.	Experiment Item	Standard
Metal Parts	1	Weather Resistance-Salt Spray	IEC 68-2-11
Mounting profile	2	Clamping force	CLEAR-defined

Dimension: mm

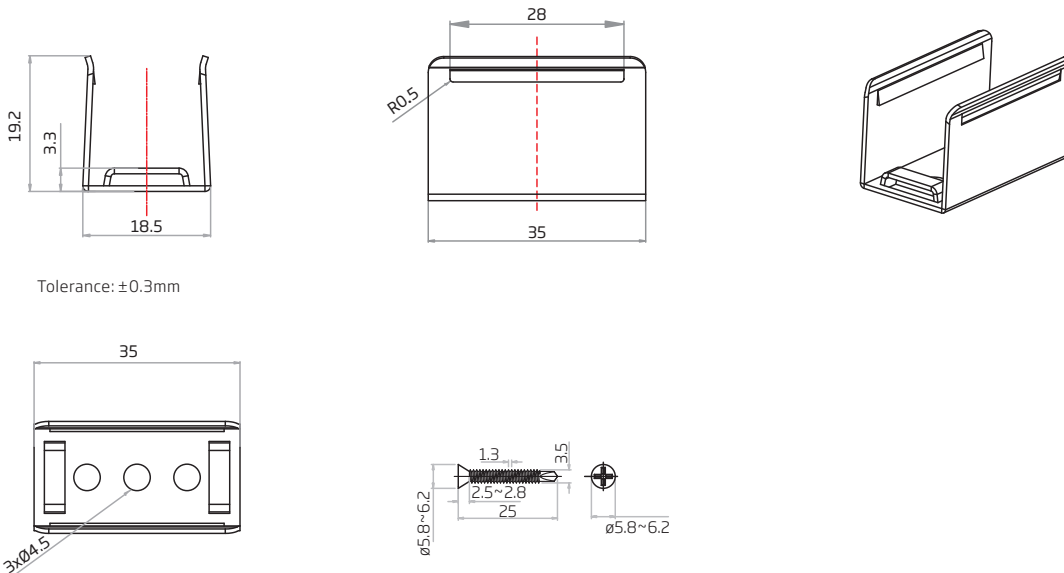

Tolerance: $\pm 0.3\text{mm}$

Item Code	Standard Length	Slotted Hole	Hole Number
F22-SS/PL-35MM-SSL	35mm/1.378in	4.5mm/0.18in	3

F22 Self-clinching Aluminum Profile

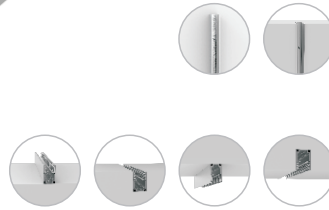

Differing from the regular aluminum profile, it has a shallower shape and symmetric protruding tracks inside to discreetly fit with the "waist" of the brand-new three-side emitting product series.

With it, the beauty of three-side emitting lights can be displayed from sides to the fullest extent, while the reliable clamping force can be expected even for the upside-down styles. The unique design of the self-clinching aluminum profile gives unlimited freedom to install three-side emitting lights in any application.

Test Object	No.	Experiment Item	Standard
Metal Parts	1	Weather Resistance-Salt Spray	IEC 68-2-11
Mounting profile	2	Clamping force	CLEAR-defined

Dimension: mm

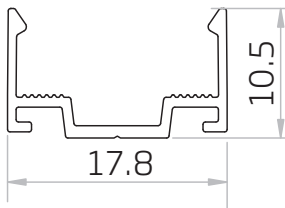

Tolerance: $\pm 0.3\text{mm}$

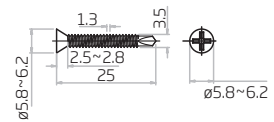
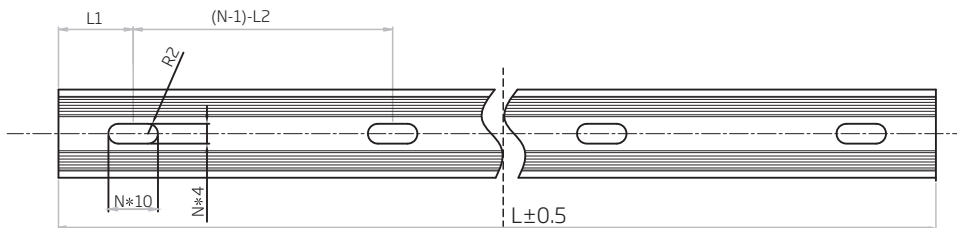
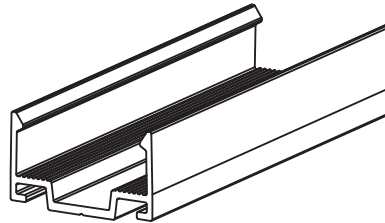

Note:
 1. L1 refers to two of symmetric L1 in each piece of profile.
 2. (N-1)-L2 refers to (N minus one) of symmetric L2 in each piece of profile.
 "N" hereby stands for its corresponding "Hole Number" in the below table

Item Code	Standard Length	L1	L2	Slotted Hole	Hole Number
F22-SCA/PL-20MM-AL	20mm/0.79in	/	/	4*10mm/0.16*0.39in	1
F22-SCA/PL-500MM-AL	500mm/19.68in	50mm/1.97in	200mm/7.87in	4*10mm/0.16*0.39in	3
F22-SCA/PL-1000MM-AL	1000mm/39.37in	100mm/3.93in	200mm/7.87in	4*10mm/0.16*0.39in	5
F22-SCA/PL-2000MM-AL	2000mm/78.74in	100mm/3.93in	200mm/7.87in	4*10mm/0.16*0.39in	10

F22 Bendable Self-clinching Aluminum Profile

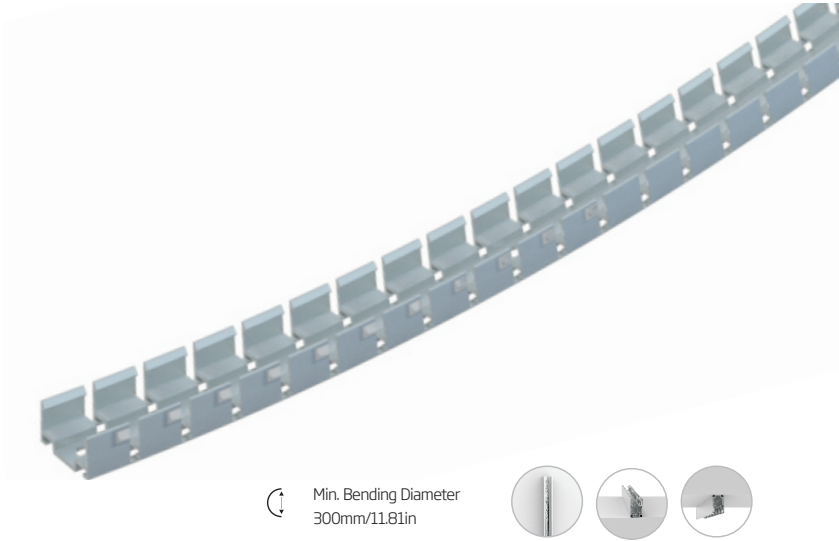

Min. Bending Diameter
300mm/11.81in

Differing from the regular aluminum profile, it has a shallower shape and symmetric protruding tracks inside to discreetly fit with the "waist" of the brand-new three-side emitting product series.

With it, the beauty of three-side emitting lights can be displayed from sides to the fullest extent, while the reliable clamping force can be expected even for the upside-down styles. The bendable property allows the lights to shape to curve lines and help brings more creative ideas to reality.

Test Object	No.	Experiment Item	Standard
Metal Parts	1	Weather Resistance-Salt Spray	IEC 68-2-11
Mounting profile	2	Clamping force	CLEAR-defined

Dimension: mm

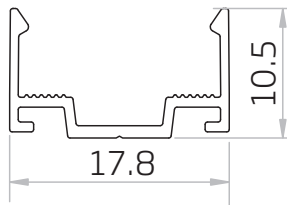

Tolerance: $\pm 0.3\text{mm}$

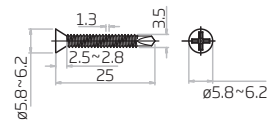
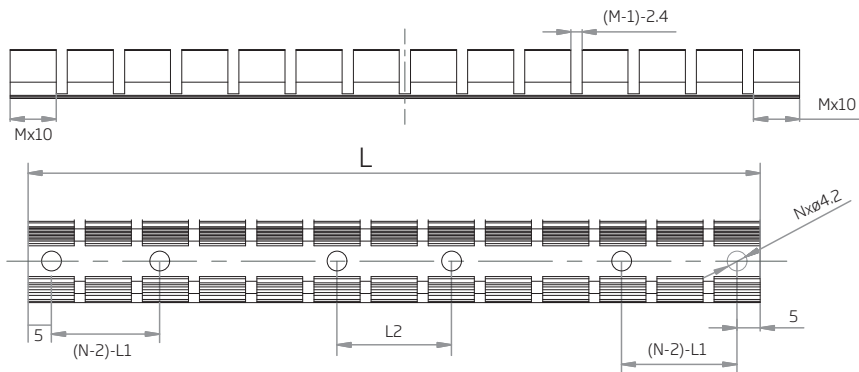
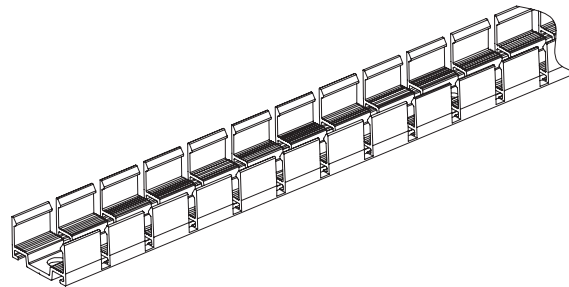

Note:

- L1 refers to two of symmetric L1 in each piece of profile.
 - (N-1)-L2 refers to (N minus one) of symmetric L2 in each piece of profile.
- "N" hereby stands for its corresponding "Hole Number" in the below table

Item Code	Standard Length	L1	L2	Slotted Hole	Hole Number
F22-BSCA/PL-VB-500MM-AL	500mm/19.68in	110.3mm/4.34in	48.9mm/1.92in	ø4.2mm/0.17in	6
F22-BSCA/PL-VB-1000MM-AL	1000mm/39.37in	116.5mm/4.59in	98.8mm/3.89in	ø4.2mm/0.17in	10

F22 Serrated Aluminum Profile

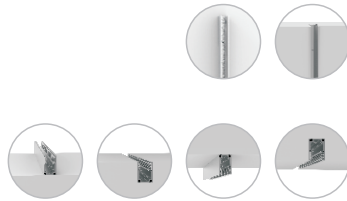

Specialized for the LED Flex Linear light, it was developed by combining the advantages of 6063 aluminum and elastic serrated tape. The inside elastic serrated tape as the grabbing force to keep continuous strong clamping force on the light body and protect the light from the damage caused by the large friction in the process of installation and dismantlement.

Please refer to the applicable installation ways.

Test Object	No.	Experiment Item	Standard
Metal Parts	1	Weather Resistance-Salt Spray	IEC 68-2-11
Mounting profile	2	Clamping force	CLEAR-defined

Dimension: mm

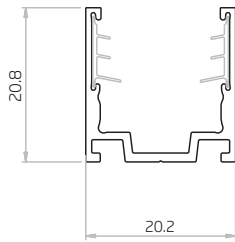

Tolerance: $\pm 0.3\text{mm}$

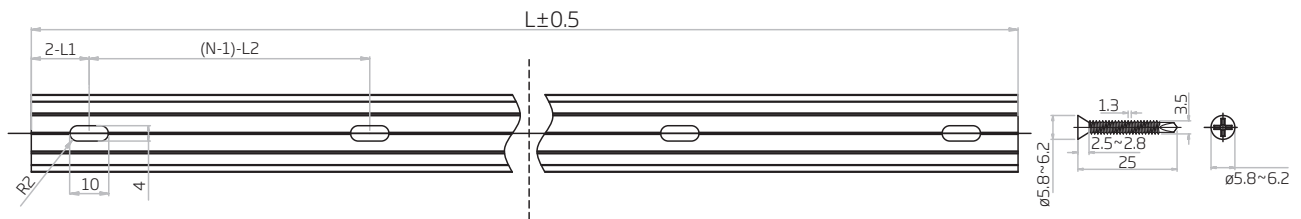
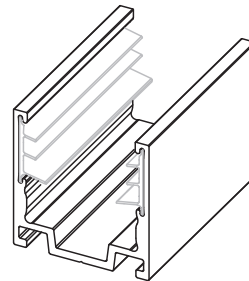

Note:
 1. 2-L1 refers to two of symmetric L1 in each piece of profile.
 2. (N-1)-L2 refers to (N minus one) of symmetric L2 in each piece of profile.
 "N" hereby stands for its corresponding "Hole Number" in the below table

Item Code	Standard Length	L1	L2	Slotted Hole	Hole Number
F22-SA/PL-20MM-AL	20mm/0.787in	10mm/0.39in	/	4*10mm/0.16*0.39in	1
F22-SA/PL-500MM-AL	500mm/19.68in	50mm/1.97in	200mm/7.87in	4*10mm/0.16*0.39in	3
F22-SA/PL-1000MM-AL	1000mm/39.37in	100mm/3.93in	200mm/7.87in	4*10mm/0.16*0.39in	5
F22-SA/PL-2000MM-AL	2000mm/78.74in	100mm/3.93in	200mm/7.87in	4*10mm/0.16*0.39in	10

F22 Flange Serrated Aluminum Profile



Specialized for the LED Flex Linear light, it was developed by combining the advantages of 6063 aluminum and elastic serrated tape. The inside elastic serrated tape as the grabbing force to keep continuous strong clamping force on the light body and protect the light from the damage caused by the large friction in the process of installation and dismantlement.

The "Flange" design is more suitable for recessed installation, better fits with the mounting groove and minimizes the operation tolerance during construction to some extent, like shielding the rough edges and the gaps of oversized groove.

Please refer to the applicable installation ways.



Test Object	No.	Experiment Item	Standard
Metal Parts	1	Weather Resistance-Salt Spray	IEC 68-2-11
Mounting profile	2	Clamping force	CLEAR-defined

Dimension: mm

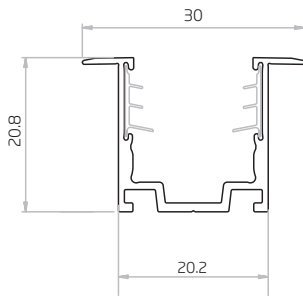

Tolerance: $\pm 0.3\text{mm}$

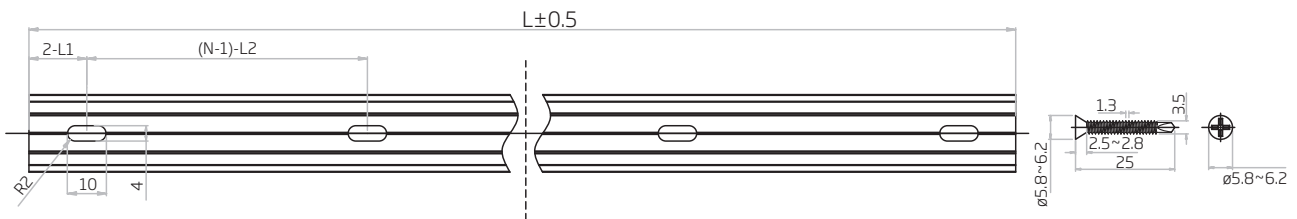
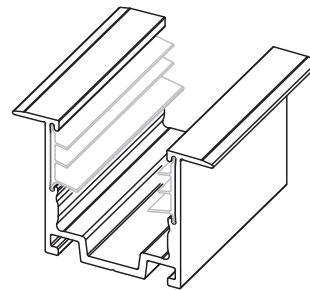

Note:

1. 2-L1 refers to two of symmetric L1 in each piece of profile.
 2. (N-1)-L2 refers to (N minus one) of symmetric L2 in each piece of profile.
- "N" hereby stands for its corresponding "Hole Number" in the below table

Item Code	Standard Length	L1	L2	Slotted Hole	Hole Number
F22-FSA/PL-20MM-AL	20mm/0.787in	10mm/0.39in	/	4*10mm/0.16*0.39in	1
F22-FSA/PL-500MM-AL	500mm/19.68in	50mm/1.97in	200mm/7.87in	4*10mm/0.16*0.39in	3
F22-FSA/PL-1000MM-AL	1000mm/39.37in	100mm/3.93in	200mm/7.87in	4*10mm/0.16*0.39in	5
F22-FSA/PL-2000MM-AL	2000mm/78.74in	100mm/3.93in	200mm/7.87in	4*10mm/0.16*0.39in	10

F22 Bendable Serrated Aluminum Profile

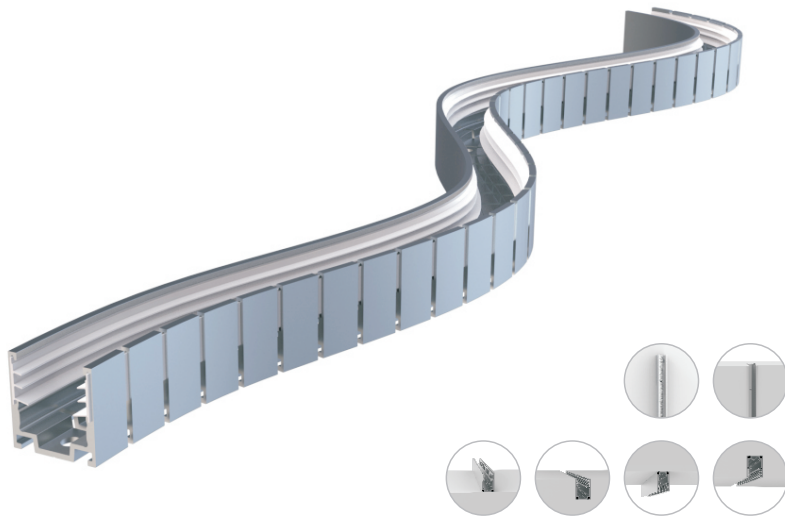

It is an expanded design of the serrated aluminum profile, and caters for the continuously streamlined aesthetics of curve shape. The secondary precision cutting process, not only maintains the advantage of clamping force, but also enables the two-way horizontal bending directions with super shape memory.

Please refer to the applicable installation ways.

Test Object	No.	Experiment Item	Standard
Metal Parts	1	Weather Resistance-Salt Spray	IEC 68-2-11
Mounting profile	2	Clamping force	CLEAR-defined

Dimension: mm

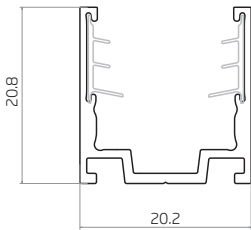

Tolerance: $\pm 0.3\text{mm}$

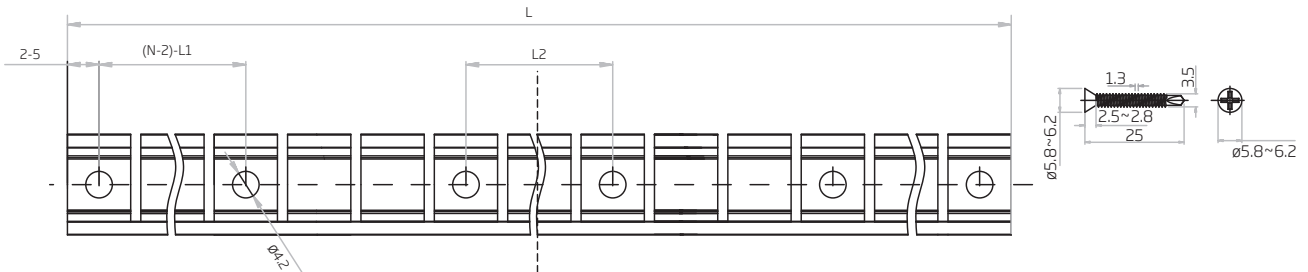
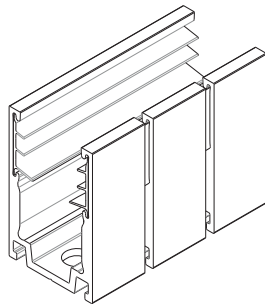

Note:
 1. 2-5 refers to two of symmetric 5mm in each piece of profile.
 2. (N-2)-L1 refers to (N minus two) of symmetric L1 in each piece of profile.
 "N" hereby stands for its corresponding "Hole Number" in the below table

Item Code	Standard Length	L1	L2	Screw Hole	Hole Number
F22-BSA/PL-500MM-AL	500mm/19.68in	110.3mm/4.34in	48.9mm/1.92in	$\phi 4.2\text{mm}/0.17\text{in}$	6
F22-BSA/PL-1000MM-AL	1000mm/39.37in	111.4mm/4.39in	98.8mm/3.89in	$\phi 4.2\text{mm}/0.17\text{in}$	10

F22 Surface-mounted Raceway Aluminum Profile

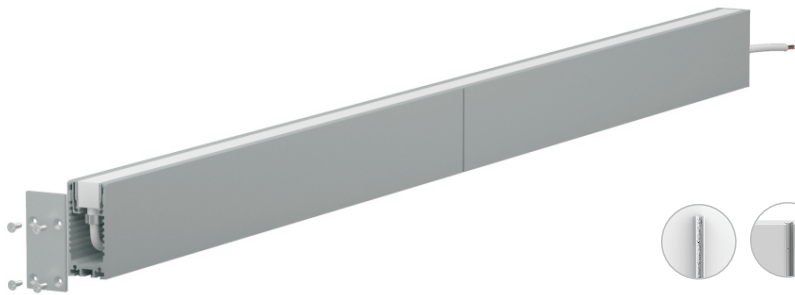

It is an expanded design of the serrated aluminum profile featuring hidden cable upon the advantage of 6063 aluminum profile.

The raceway space is up to 570mm², enough to conceal injection-moulded connector with bottom feed and the general male/female connectors.

It is superb for the facade where tidiness is required and the scenarios that lack of space for wiring.



Please refer to the applicable installation ways.

Test Object	No.	Experiment Item	Standard
Metal Parts	1	Weather Resistance-Salt Spray	IEC 68-2-11
Mounting profile	2	Clamping force	CLEAR-defined

Dimension: mm

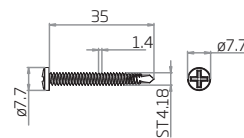
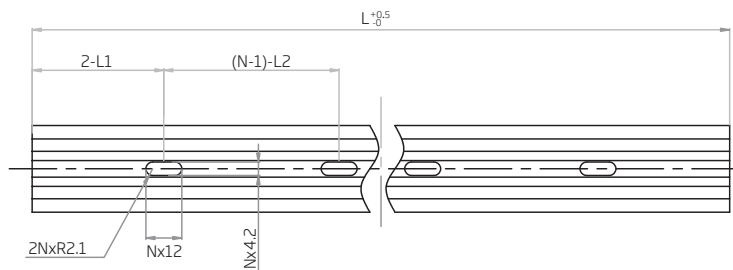
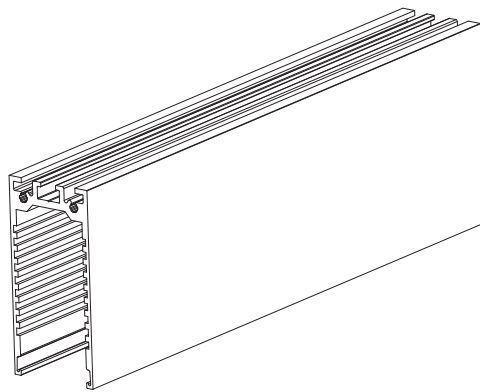
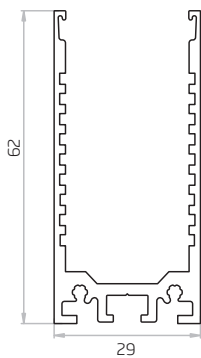

Note:

1. 2-L1 refers to two of symmetric L1 in each piece of profile.
 2. (N-1)-L2 refers to (N minus one) of symmetric L2 in each piece of profile.
- N hereby stands for its corresponding Hole Number in the below table

Item Code	Standard Length	L1	L2	Slotted Hole	Hole Number
F22-SMR/PL-500MM-AL	500mm/19.68in	50mm/1.97in	200mm/7.87in	4.5*12mm/0.18*0.47in	3
F22-SMR/PL-1000MM-AL	1000mm/39.37in	100mm/3.94in	200mm/7.87in	4.5*12mm/0.18*0.47in	5
F22-SMR/PL-2000MM-AL	2000mm/78.74in	100mm/3.94in	200mm/7.87in	4.5*12mm/0.18*0.47in	10

F22 Surface-mounted Raceway Aluminum Profile

Main Components

Outer Aluminum Profile		Inner Aluminum Profile	
<p>PA4.2*35 Self-tapping Screws</p>			
Retaining Bracket for Inner and Outer Profiles	Joining Bracket for Outer Profiles	End Cover	End Cover with Cable Hole
<p>PM4*6 Screws</p>	<p>No screws here</p> <p>PMW4*18 Screws, BSOS-M4*5 Self-clinching Standoffs</p>	<p>KM3*8 Screws</p>	<p>KM3*8 Screws</p>

Exploded View

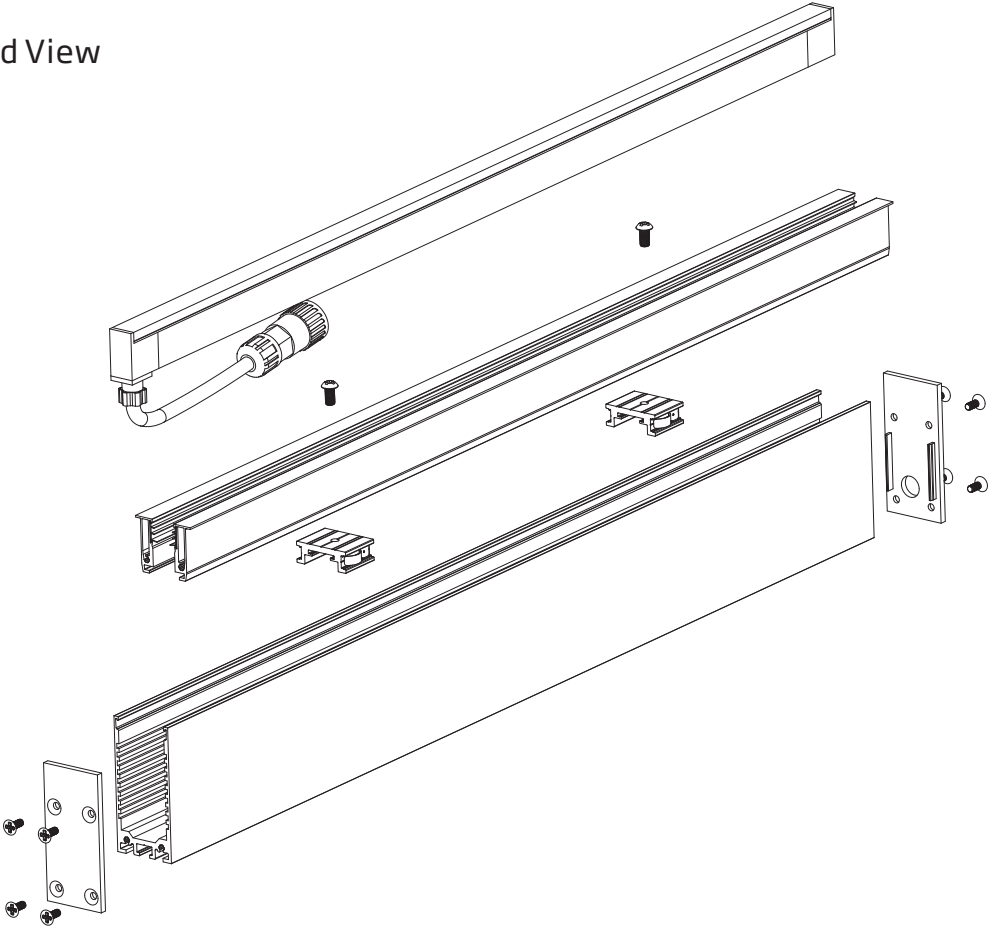

F22 Suspended Raceway Aluminum Profile

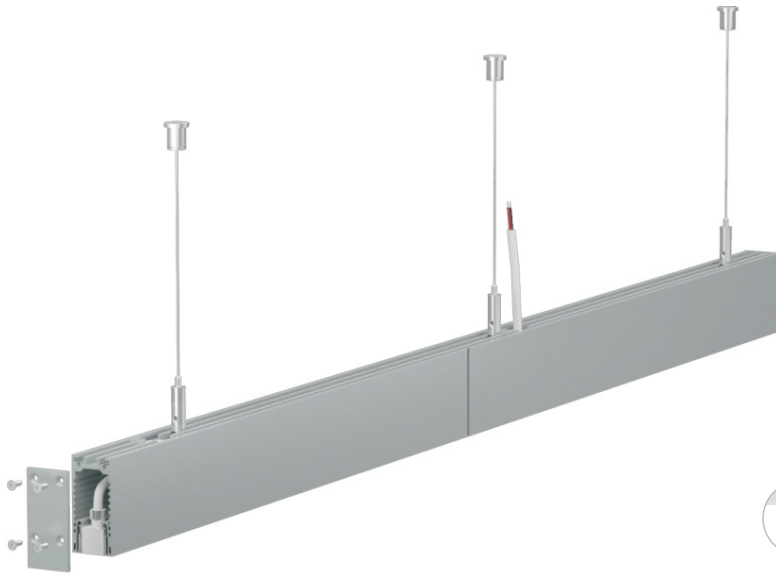

Suspended Mounting

It is an expanded design of the serrated aluminum profile featuring hidden cable upon the advantage of 6063 aluminum profile.

The raceway space is up to 570mm², enough to conceal injection-moulded connector with bottom feed and the general male/female connectors. It is superb for the facade where tidiness is required and the scenarios that lack of space for wiring.



Please refer to the applicable installation ways.

Test Object	No.	Experiment Item	Standard
Metal Parts	1	Weather Resistance-Salt Spray	IEC 68-2-11
Mounting profile	2	Clamping force	CLEAR-defined

Dimension: mm

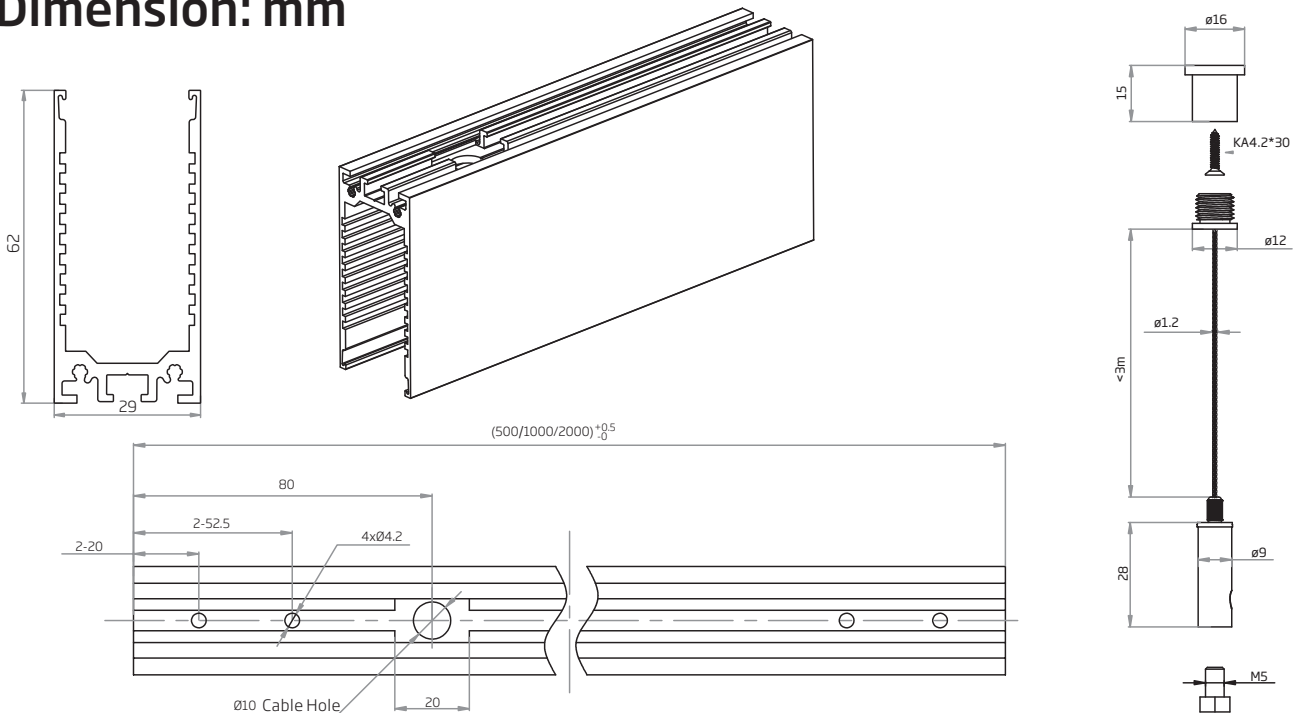

Item Code	Standard Length
F22-SR/PL-500MM-AL	500mm/19.68in
F22-SR/PL-1000MM-AL	1000mm/39.37in
F22-SR/PL-2000MM-AL	2000mm/78.74in

F22 Suspended Raceway Aluminum Profile

Main Components

Outer Aluminum Profile		Inner Aluminum Profile		
Retaining Bracket for Inner and Outer Profiles	Joining Bracket for Outer Profiles	Suspended Ceiling Kit	End Cover	Rubber Grommet
<p>PM4*6 Screws</p>	<p>PMW4*30 Screws</p>	<p>Cable Coupler Steel Wire Cable Gripper KA4.2*30 Screws</p>	<p>KM3*8 Screws</p>	

Exploded View

